

ALL PLANS TO BE READ AND CO-ORDINATED IN
CONJUNCTION WITH ALL OTHER PROFESSIONAL
CONSULTANTS DRAWINGS

All materials, fittings, etc. specified on the drawings under a trade name, catalogue number or reference, must be exactly as described. Any other product of equal quality may be used subject to the Architect's written approval.

All building works to be of a higher quality as per Architect's approval above the building industry's accepted average.



health
Department:
Health
REPUBLIC OF SOUTH AFRICA

--

CONSULTIUM 
ARCHITECTS & URBAN DESIGNERS

ARCHITECTURE – WORKING DRAWINGS

MKHONDO COMMUNITY HEALTH CLINIC
ERF NO: 1827 ETHANDAKUKHANYA
2 BEDROOM STAFF
HOUSING UNIT FOR MPUMALANGA CLINIC

SECTION A-A
SECTION B-B

drawing no. N10/09/08/ WD 006

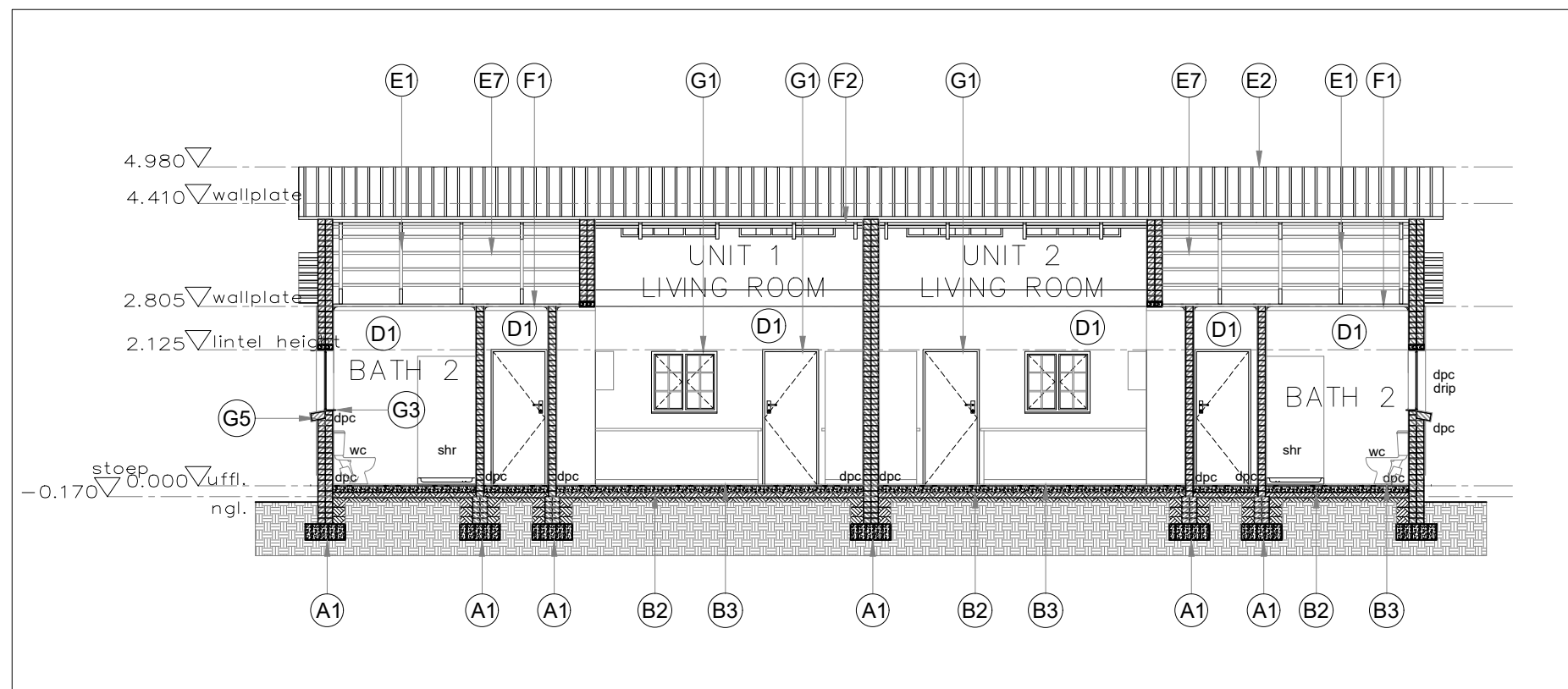

SECTIONS A-A
Sale 1:100

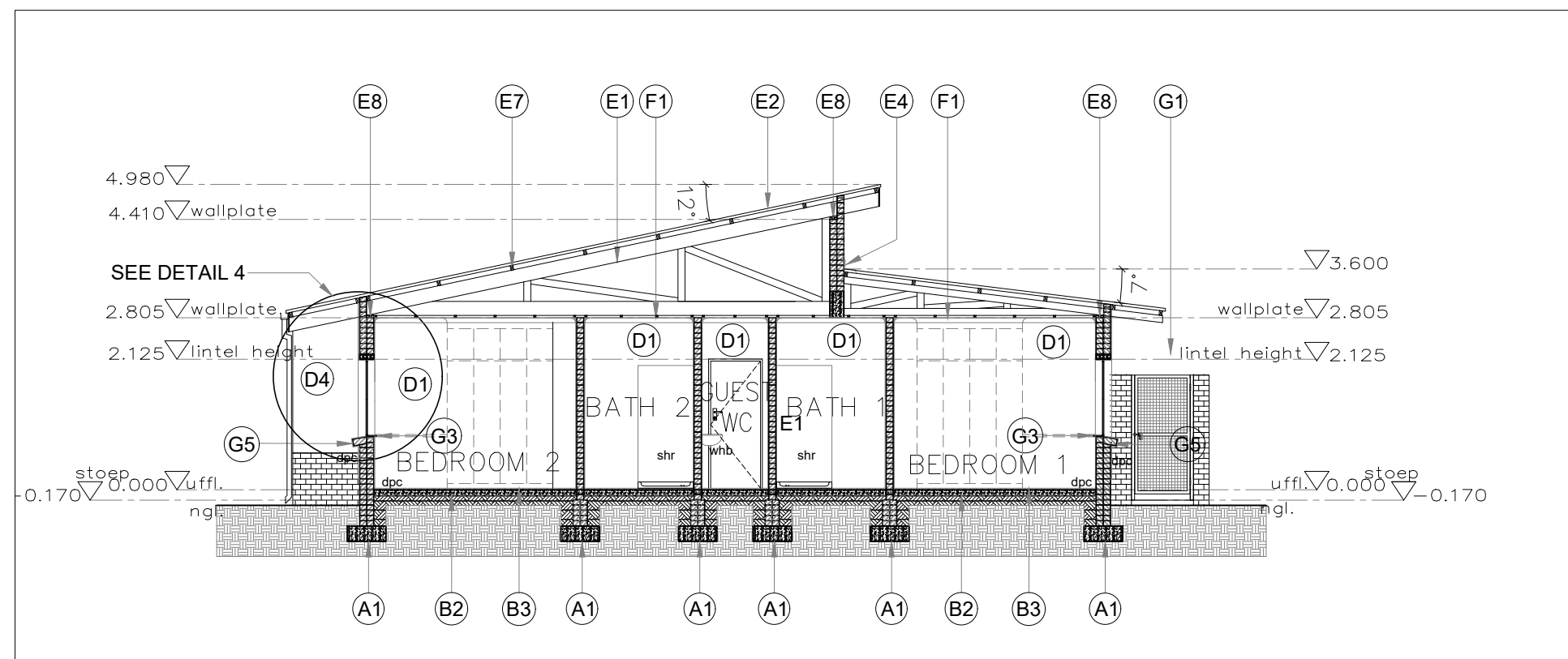

SECTIONS B-B
Sale 1:100